



CAUTION

Before use, refer to the CAPR[®] User's Instructions, P/N 03521015 (received with all CAPR Helmets) for System Details, and to the 2073-03 Hard Hat Helmet Instructions For Use, P/N 01023568.



O.N. 2061-04A
 P/N 01031528

Symbol Definitions



Warning, Caution, or Note

O.N.

Order Number

P/N

Part Number



WARNING

Use only if package is received unopened and contents are undamaged. If damage is noted, contact the shipper for replacement or repair.

Prior to using any MAXAIR[®] System or component, be sure to be familiar with the system's NIOSH approved configuration.

DO NOT use if any component is damaged. If any components are damaged or contaminated and therefore unfit for safe and effective use, they should be replaced immediately.

Only trained and experienced personnel who have read and understand the User's Instructions should use this product.

Failure to follow the User's Instructions, these and in the MAXAIR Systems User's Instructions, P/N 03521015, may be hazardous to the user's health.

The institution using this product in any application is responsible for determining the appropriateness of this equipment relative to regulatory requirements. Bio-Medical Devices Intl, Inc. does not recommend the appropriate systems for a particular institution or facility.

Use only MAXAIR Systems/ NIOSH approved compatible components.

NOT for use in atmospheres immediately dangerous to life or health (IDLH), and atmospheres containing less than 19.5% oxygen, or more than 25% oxygen.

If you need more information, contact your BMDI Sales Representative, or call BMDI customer service at 1-800-443-3842.

Intended Use

The MAXAIR CAPR Hard Hat is part of a system intended to filter aerosolized and droplet particulates, and to provide head protection.

For Use With

Typically, the Hard Hat is part of the 2073-03 Hard Hat Helmet, and used with a 2400-090L Impact Lens, and either a HH Shroud or a HH Cuff, alternate Filter Cartridges and alternate Batteries, per tables below.

Typical System Components for Hard Hat Use



1. 2073-03 Hard Hat Helmet: Hard Hat, Helmet, HH Liner, and Power Cord	2. 2500-30TSC Li-Ion Battery (16-20 Hr/Charge)
	3. 2000-76 Battery Belt
	4. 2600-01 Battery Charger

Accessories



2167-10 XP Filter Cartridge	2264-01 ML & SM DLC Shroud	2366-02 ML & SM DLC Lens-Cuff
-----------------------------------	-------------------------------	----------------------------------



NOTE

The 2500-36TSC (8-10 Hr/Charge) is an alternate battery.

Specifications

Temperature Limits: 49°C

Materials

Hard Hat is Kevlar, reinforced

Regulatory

NIOSH
 ANSI/ISEA Z98.1-2014 Type 1, Class G & C

CAUTION
 Before use, refer to the CAPR[®] User's Instructions, P/N 03521015 (received with all CAPR Helmets) for System Details, and to the 2073-03 Hard Hat Helmet Instructions For Use, P/N 01023568.

NOTE
 The 2073-03 comes assembled, consisting of the Helmet, LIner, Hard Hat, and Power Cord. The following describes the assembly and disassembly of the 2061-04A Hard Hat to the Helmet.

Assembly - Hard Hat to Helmet



1. Locate the inside hole in the Hard Hat front Turn Clip, and the Helmet front Snap.



2. Place the Helmet front snap securely in the Hard Hat front Turn Clip inside hole.

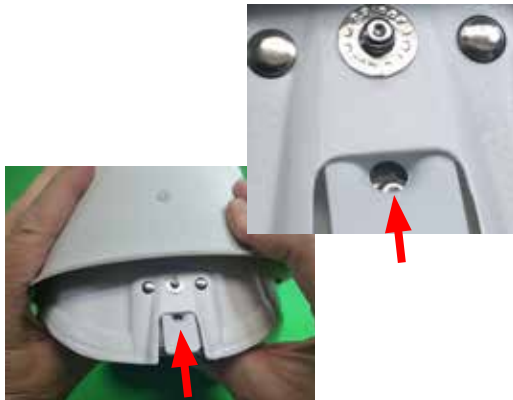

3. Pull the Hard Hat down over the back of the Helmet until its T-Tab hole is over the top rear Snap on the Helmet back.



4. Continue downward movement of the Hard Hat until its T-Tab hole snaps securely on the Helmet snap.



Hard Hat assembled to Helmet

Disassembly - Hard Hat from Helmet

To disassemble the Hard Hat from the Helmet, reverse the Assembly steps 1-4, above.

Order Number - Part Number Reference

ITEM	O.N.	P/N	ITEM	O.N.	P/N
Hard Hat Helmet	2073-03	03531001, 01031528, 03531148, 2590-05	Impact Lens	2400-090L	03531190
			Li-Ion Battery, 16-20 Hr/Charge	2500-30TSC	01532117
			Li-Ion Battery, 8-10 Hr/Charge	2500-36TSC	01532105
Hard Hat	2061-04A	01031528	Battery Belt	2000-76	2000-76
Hard Hat Liner	2071-03	03531148	Battery Charger	2600-01	01432089
XP Filter Cartridge	2167-10	01031569	Power Cord	2590-05	2590-05